

# CT12-80XD 12V 80Ah(10hr)

The rechargeable batteries are lead-lead dioxide systems. The dilute sulfuric acid electrolyte is absorbed by separators and plates and thus immobilized. Should the battery be accidentally overcharged producing hydrogen and oxygen, special one-way valves allow the gases to escape thus avoiding excessive pressure build-up. Otherwise, the battery is completely sealed and is, therefore, maintenance-free, leak proof and usable in any position.



## Battery Construction

| Component    | Positive plate | Negative plate | Container | Cover | Safety valve | Terminal | Separator  | Electrolyte   |
|--------------|----------------|----------------|-----------|-------|--------------|----------|------------|---------------|
| Raw material | Lead dioxide   | Lead           | ABS       | ABS   | Rubber       | Copper   | Fiberglass | Sulfuric acid |

## General Features

- Absorbent Glass Mat (AGM) technology for efficient gas recombination of up to 99% and freedom from electrolyte maintenance or water adding.
- Not restricted for air transport-complies with IATA/ICAO Special Provision A67.
- UL-recognized component.
- Can be mounted in any orientation.
- Computer designed lead, calcium tin alloy grid for high power density.
- Long service life, float or cyclic applications.
- Maintenance-free operation.
- Low self discharge.

## Dimensions and Weight

Length(mm / inch).....564 / 22.20  
 Width(mm / inch).....115 / 4.53  
 Height(mm / inch).....189 / 7.44  
 Total Height(mm / inch).....189 / 7.44  
 Approx. Weight(Kg / lbs).....28.2 / 62.2

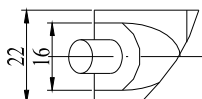
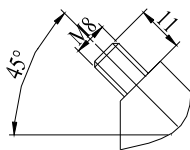
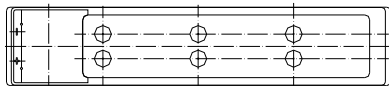
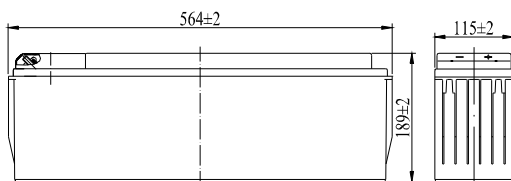

## Performance Characteristics

Nominal Voltage .....12V  
 Number of cell .....6  
 Design Life .....12 years  
 Nominal Capacity 77°F(25°C)  
 10 hour rate (8A, 10.8V)..... 80Ah  
 5 hour rate (14.5A, 1.75V)..... 72.5Ah  
 1 hour rate (52.3A, 9.6V) ..... 52.3Ah  
 Internal Resistance  
 Fully Charged battery 77°F(25°C)..... 7mOhms  
 Self-Discharge  
 3% of capacity declined per month at 20°C(average)  
 Operating Temperature Range  
 Discharge .....-20~60°C  
 Charge .....-10~60°C  
 Storage .....-20~60°C  
 Max. Discharge Current 77°F(25°C) .....800A(5s)  
 Short Circuit Current .....1500A  
 Charge Methods: Constant Voltage Charge 77°F(25°C)  
 Cycle use .....14.4-14.7V  
 Maximum charging current .....24A  
 Temperature compensation .....-30mV/°C  
 Standby use .....13.6-13.8V  
 Temperature compensation .....-20mV/°C

## Discharge Constant Current (Amperes at 77°F25°C)

| End Point Volts/Cell | 10min | 15min | 30min | 45min | 1h   | 3h   | 5h   | 10h  |
|----------------------|-------|-------|-------|-------|------|------|------|------|
| 1.60V                | 182   | 148   | 81.1  | 62.7  | 52.3 | 22.3 | 14.8 | 8.45 |
| 1.65V                | 174   | 141   | 79.7  | 59.8  | 49.8 | 22.0 | 14.7 | 8.35 |
| 1.70V                | 165   | 135   | 78.3  | 56.9  | 47.5 | 21.9 | 14.6 | 8.24 |
| 1.75V                | 156   | 128   | 76.9  | 54.0  | 45.0 | 21.6 | 14.5 | 8.14 |
| 1.80V                | 146   | 122   | 74.4  | 50.3  | 42.3 | 21.0 | 14.2 | 8.00 |

## Discharge Constant Power (Watts at 77°F25°C)

| End Point Volts/Cell | 10min | 15min | 30min | 45min | 1h   | 2h   | 3h   | 5h   |
|----------------------|-------|-------|-------|-------|------|------|------|------|
| 1.60V                | 313   | 262   | 149   | 117   | 98.7 | 55.3 | 42.4 | 28.2 |
| 1.65V                | 300   | 251   | 147   | 112   | 94.0 | 54.1 | 42.1 | 28.2 |
| 1.70V                | 288   | 240   | 145   | 107   | 90.2 | 52.9 | 41.9 | 28.2 |
| 1.75V                | 275   | 229   | 143   | 102   | 86.0 | 51.7 | 41.6 | 28.1 |
| 1.80V                | 259   | 218   | 139   | 95.9  | 81.2 | 49.8 | 40.7 | 27.6 |

(Note)The above characteristics data are average values obtained within three charge/discharge cycles not the minimum values.

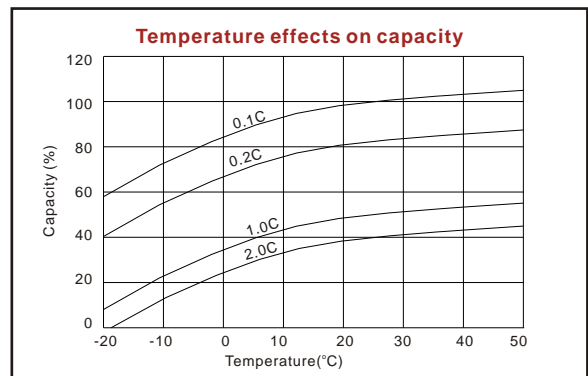
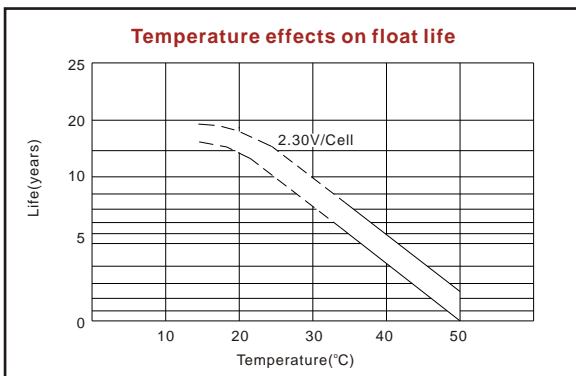
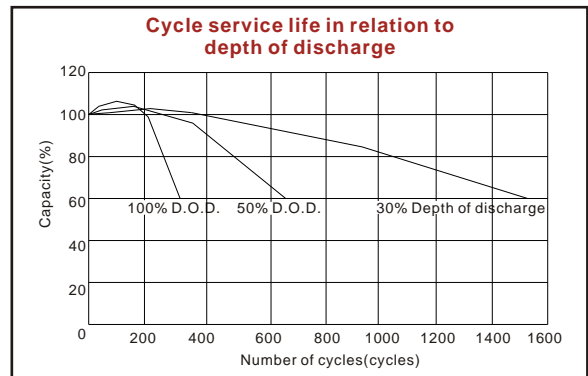
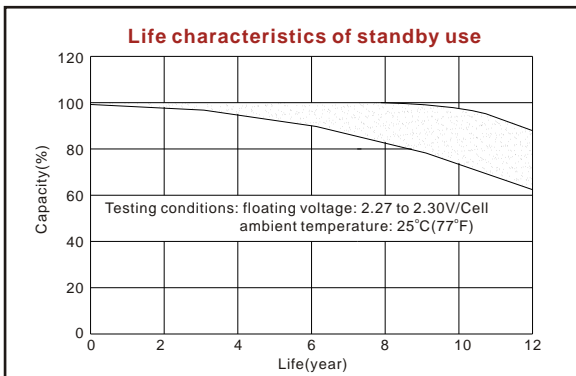
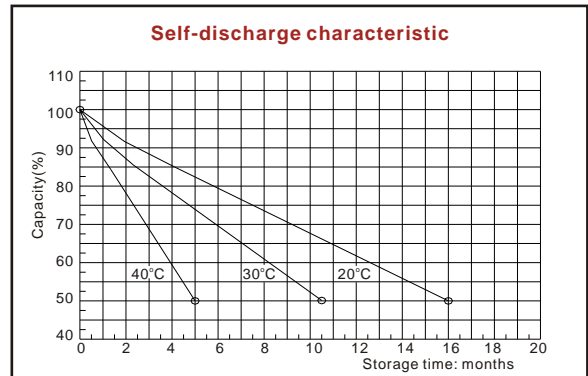
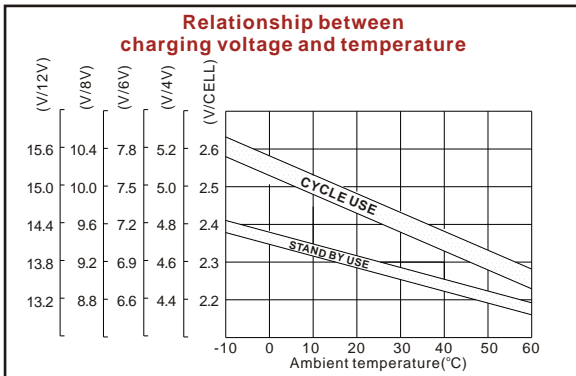
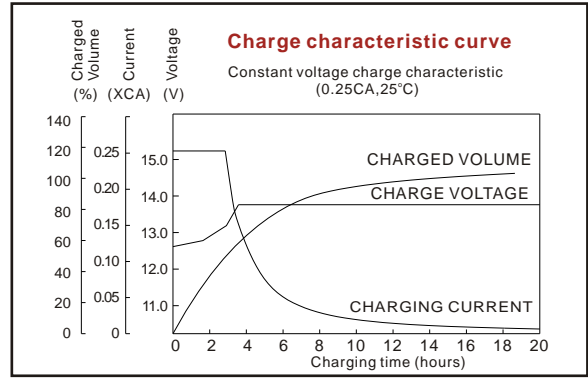
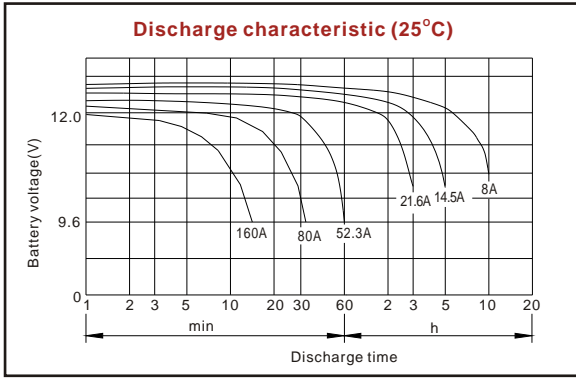

ISO9001:2000

MH25860

G4M19906-9202-E-16

[www.vision-batt.com](http://www.vision-batt.com)

**Shenzhen Center Power Tech. Co., Ltd.**  
 Center Power Industrial Park, Tongfu Industrial District Dapeng Town, 518120 Shenzhen, China  
 Tel: (+86-755) 8431 8088 Fax: (+86-755) 8431 8038 E-mail: sales@vision-batt.com